

Los Angeles County
Metropolitan
Transportation
Authority

One Gateway Plaza
Los Angeles, CA
90012

213.922.6000

Mailing Address:
P.O. Box 194
Los Angeles, CA 90053

February 16, 1996

TO: MTA BOARD OF DIRECTORS
FROM: STANLEY G. PHERNAMBUCO 
SUBJECT: MTA CONSTRUCTION NONCONFORMANCE REPORTS

Attached please find copies of the Nonconformance Reports (NCRs) received by the MTA Director of Quality Management for the period of February 9-15, 1996.

If you have any questions, please call Bill Moore, Director of Quality Management, at 213-244-6109.

SGP:WRM:gg [MEMO/NCR-CVR]

Attachments

cc: John Adams, USG 18
Dave Sievers, USG 18-05
Charles Stark, USG 16-01
Steve Polechronis, USG 16
Elaine Stewart, USG 17
Bill Moore, USG 24-03
Kim Kimball, USG 25
Judy Schwartz, USG 25-03
Al Larado, USG 20-21



Metropolitan Transportation Authority

Nonconformance Report

May Affect ROD

Yes No NA

 Initials Date

Page 1 of

1. Line: MRL	Contract No.: B241	Year: 96	NCR No.: 203.00	2. Contract Name: VERMONT/BEVERLY STATION	3. Date: 02/02/96
4. Location: NOTRH END OF THE STATION.		5. NCR Type: Submittals		6. Contractor/Supplier: TUTOR-SALIBA/PERINI	
7. Specification Section/Drawing No.: 01300.1.2.B /			8. Originator: GENE JORDAN <i>FOR: Ralph Ratliff</i>		Phone No.: (213) 644-1986
9. Contract Requirement: The contractor shall not start work for which submittals are required until submittals bearing the stamp of the commission or its designee, and signatures indicating review and approval, have been received. Also, B-241 specifications no. 01300.2.2.C, 01300.3.3.E & 03100.1.3.c.1. Nonconformance Description: The contractor began the installation of the shoring for the Upper Ancillary Level on 2/2/96 at 6:30am for lifts 8, 9 & 10. The submittal for this shoring, no. B-241-03100-22.01, was still being reviewed by EMC when the work started.					
10. Lead Inspector: RALPH RATLIFF <i>Ralph Ratliff</i>		Date: 02/02/96		11. Reply Requested From: BRYAN LEE/TONY CORSINI	
12. Reply Due Date: 02/02/96					
13. Root cause of the problem and action(s) to prevent recurrence (Completed by the contractor):					
14. Corrective action(s) (Completed by the contractor):					
15. Prepared By:		Date:		16. Implementation Date:	
				17. RE Approval:	
				Date:	
18. Disposition Status: <input type="checkbox"/> Reject <input type="checkbox"/> Rework <input type="checkbox"/> Repair <input type="checkbox"/> Use-As-Is					
19. Engineer Approval: Print Name:			Signature:		Date:
(Repair and Use-As-Is):					
20. Lead Inspector: Date:					
21. Verification that nonconforming condition has been corrected:					
22. Inspection:					
Print Name:			Signature:		Date:



Metropolitan Transportation Authority

Case
2/15/96

Nonconformance Report
(Continuation Page)

Page 2 of

Contract No.: C331	4. Location: OVER AR TUNNEL	3. Date: 01/25/96	NCR No.: 98.00
------------------------------	---------------------------------------	-----------------------------	--------------------------

Contract Requirement:

Grout holes that are lost or damaged due to mechanical failure of the equipment, inadequacy of grout supply, or improper injection procedure shall be properly filled and replaced by other holes, at no additional cost to the Authority.

Nonconformance Description:

Holes at 986+37sw and 986+37se would not take grout in bottom ports. -more grout was injected from adjacent hole(986+37 nw) apparently to compensate. (this is freeway contract grouting)

WRM 2/14/96

May Affect ROD		
<input type="checkbox"/>	<input type="checkbox"/>	<input type="checkbox"/>
Yes	No	NA
_____		_____
Initials		Date

Nonconformance Report

1. Line: Red	Contract No.: 351	Year: 96	NCR No.: 08	2. Contract Name: North Hollywood Station		3. Date: 02-09-96
4. Location WEST CAP WALER NO.03			5. NCR Type:		6. Contractor/Supplier: Kajima / Ray Wilson	
7. Specification Section/Drawing No.: 02160			8. Originator: Frank Frascati		Phone No.: 818-508-3210	Hold Tag No.
9. Contract requirement and nonconformance description: CAP WALER INSTALLATION NOT IN ACCORDANCE WITH APPROVED DRAWINGS. i.e. THE bottom FLANGE IS CUT OUT TO PROVIDE CLEARANCE FOR W3 WATER LINE IN S. CHANDLER ST. CUT OUT IS 4"x15" OUT OF BOTTOM FLANGE OF CAP WALER WCW3, 2.5' SOUTH OF PILE NO.W11 AND 1.16' NORTH OF DECK BEAM NO. 06.						
Lead Inspector: Frank Frascati <i>Frank Frascati</i>		Date: 02-09-96 <i>02-09-96</i>		11. Reply requested from: <i>Kajima/Ray Wilson</i>		12. Reply due date: <i>2/26/96</i>
13. Root cause of the problem and action(s) to prevent recurrence (completed by the contractor):						
14. Corrective action(s) (completed by the contractor):						
15. Prepared By:		Date:	16. Implementation Date:		17. RE Approval: _____ Date:	
18. Disposition status: <input type="checkbox"/> Reject <input type="checkbox"/> Rework <input type="checkbox"/> Repair <input type="checkbox"/> Use-As-Is						
19. Engineer approval (Repair and Use-As-Is):			Print Name:	Signature:	Date:	20. Lead Inspector: _____ Date:
21. Verification that nonconforming condition has been corrected:						
22. Inspection:						
			Print Name		Signature	
					Date	



PARSONS-DILLINGHAM

Daily Inspection Report
(Continuation Sheet)

Page _____ of _____

Contract No.:	C351	Date:	02-09-96
Contractor:	KRW	Contract Day No.	253



NCR No. 08. : 4"X 15" window cut out of bottom flange of West cap waler no. WCW3 at 2.5' south of pile W11 and 1.16' north of deck beam no.6.

In Compliance with Spec. Section/s:	02160	Yes:	No: X
-------------------------------------	-------	------	-------

Inspector's Name: Frank Frascati
(Print Name)

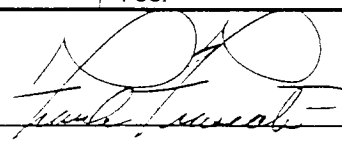
Signature: 

Form 143 (4/93)

Time In:	0600 hr.	Time Out:	Hours:
----------	----------	-----------	--------

RECEIVED

OCT 09 1995

NONCONFORMANCE REPORT
MANAGERS OF TRANSIT CONSTRUCTION

Initials: DW
Date: 1-21-95

Page of

1. Line: Contract No: C 6430	Year: 95	NCR No.: # 20	2. Contract Name: ARROYO SECO BRIDGE	3. Date: 09 / 21 / 95
---------------------------------	-------------	------------------	---	--------------------------

4. Location: CIDH PILE #399 STA. 399 + 57.85	5. NCR Type: CIDH PILE	6. Contractor/Supplier: GENCE CORP.
---	---------------------------	--

7. Specification/Drawing No.: 02387-1 E.1.b	8. Originator: TED LEPE	Phone Number: (213) 258-7284
--	----------------------------	---------------------------------

9. Nonconformance description and contract requirements: THE ABOVE LISTED PILE IS IN VIOLATION OF THE ALLOWED 3" TOLERANCE AS SPECIFIED IN SECTION 02387-1. 2 E. 1.b

10. Resident Engineer: <i>Tom C. Walker</i> Date: 2/21/95	11. Reply requested from: KIEWIT PACIFIC JEFF ENNIS	12. Reply due date: 09-28-95
--	--	---------------------------------

13. Root cause of the problem (completed by contractor):
UNKNOWN - ALL OF THE NECESSARY LAYOUT HAS BEEN PROVIDED BY KIEWIT PACIFIC CO. TO GET THE PILE CAGES IN THE CORRECT LOCATION. THE SUBCONTRACTOR JUST FAILED TO DO SO.

14. Corrective action(s) to prevent recurrence (completed by contractor):
THE SUBCONTRACTOR, GENCE CORP., IS ALIGNING THE PILE CAGES BETWEEN THE OFFSETS PROVIDED. GENCE CORP. HAS OFFERED THE ATTACHED SOLUTION TO CORRECT PILE # 399.

15. Prepared by: J. ENNIS	Date: 10-6-95	16. Implementation Date: ASAP	17. RE Approval: <i>Tom C. Walker</i>	Date: 10/11/95
------------------------------	------------------	----------------------------------	--	-------------------

18. Disposition:

Reject Rework Repair Use-As-is

19. Engineer Approval: See sketches for additional reb. etc.	Print Name: N. P. PANDYA	Signature: <i>N. P. Pandya</i>	Date: 10-23-95	20. Resident Engineer: <i>Tom C. Walker</i>	Date: 1/31/96
---	-----------------------------	-----------------------------------	-------------------	--	------------------

21. Verification that nonconforming condition has been corrected:
Pile # 399 N C R #20 all correction made per. EMC response
Work was completed on 12/29/95 see attached sheets

2. Inspection:

Print Name: *TED LOPE* Signature: *Ted Lepe* Date: 1-31-96

ENK 1/31/96



Managers of Transit Construction

Pasadena Blue Line
TEAMETRO
Partnership for Excellence in Rail Construction

ITEM DESCRIPTION -

CIDH Pile #399 @ Sta. 399 + 57.85
REDRAWN FROM GENCO SKETCH

CONTRACT NO. _____

CONTRACT NAME _____

CALC'D BY _____ DATE _____

CHK'D BY _____ DATE _____

SHEET ____ OF ____

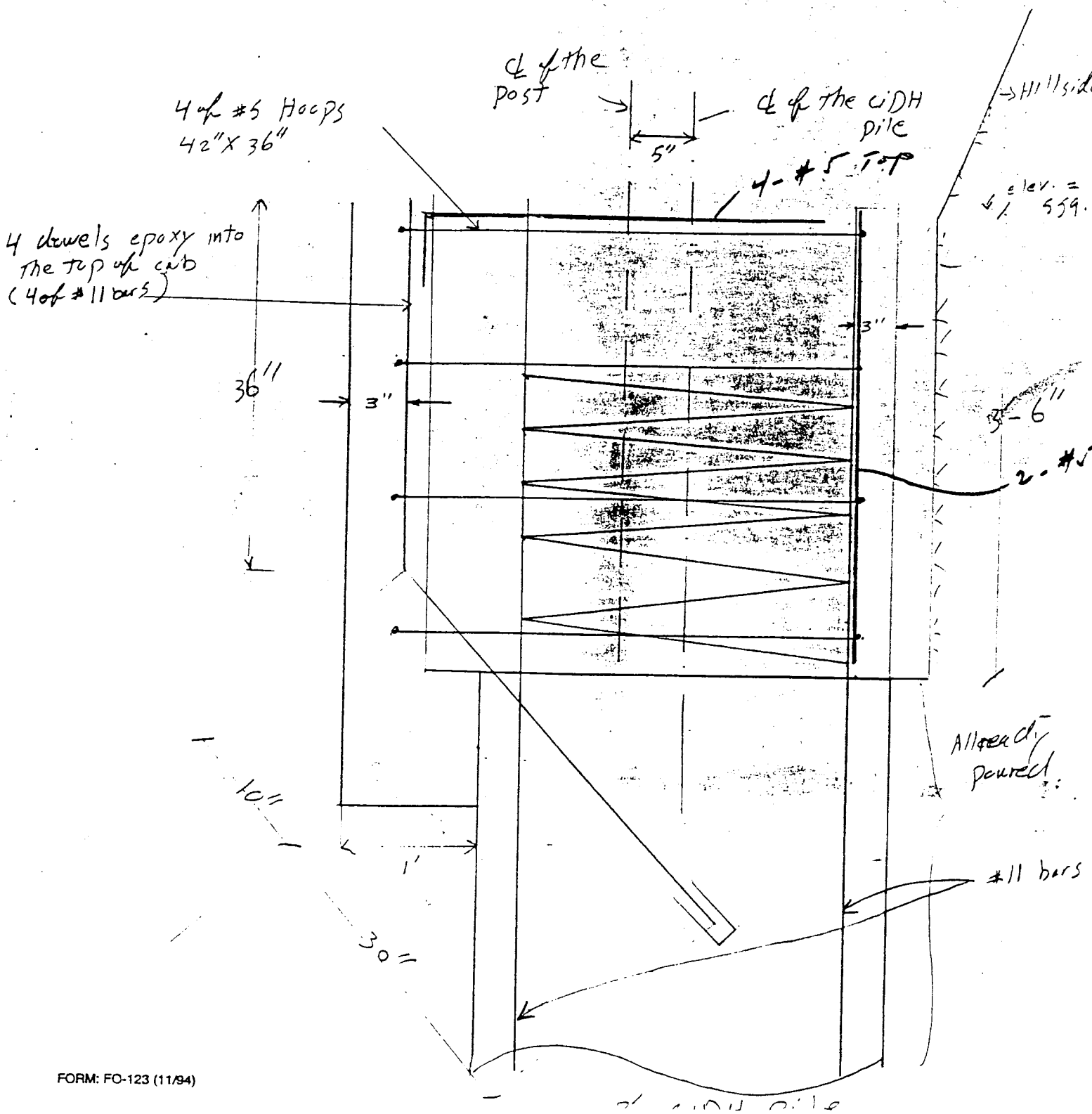



Managers of Transit Construction

Pasadena Blue Line
TEAMETRO
Partnership for Excellence in Rail Construction

ITEM DESCRIPTION -

CONTRACT NO. _____

CONTRACT NAME _____

CALCD BY _____ DATE _____

CHKD BY _____ DATE _____

SHEET ____ OF ____

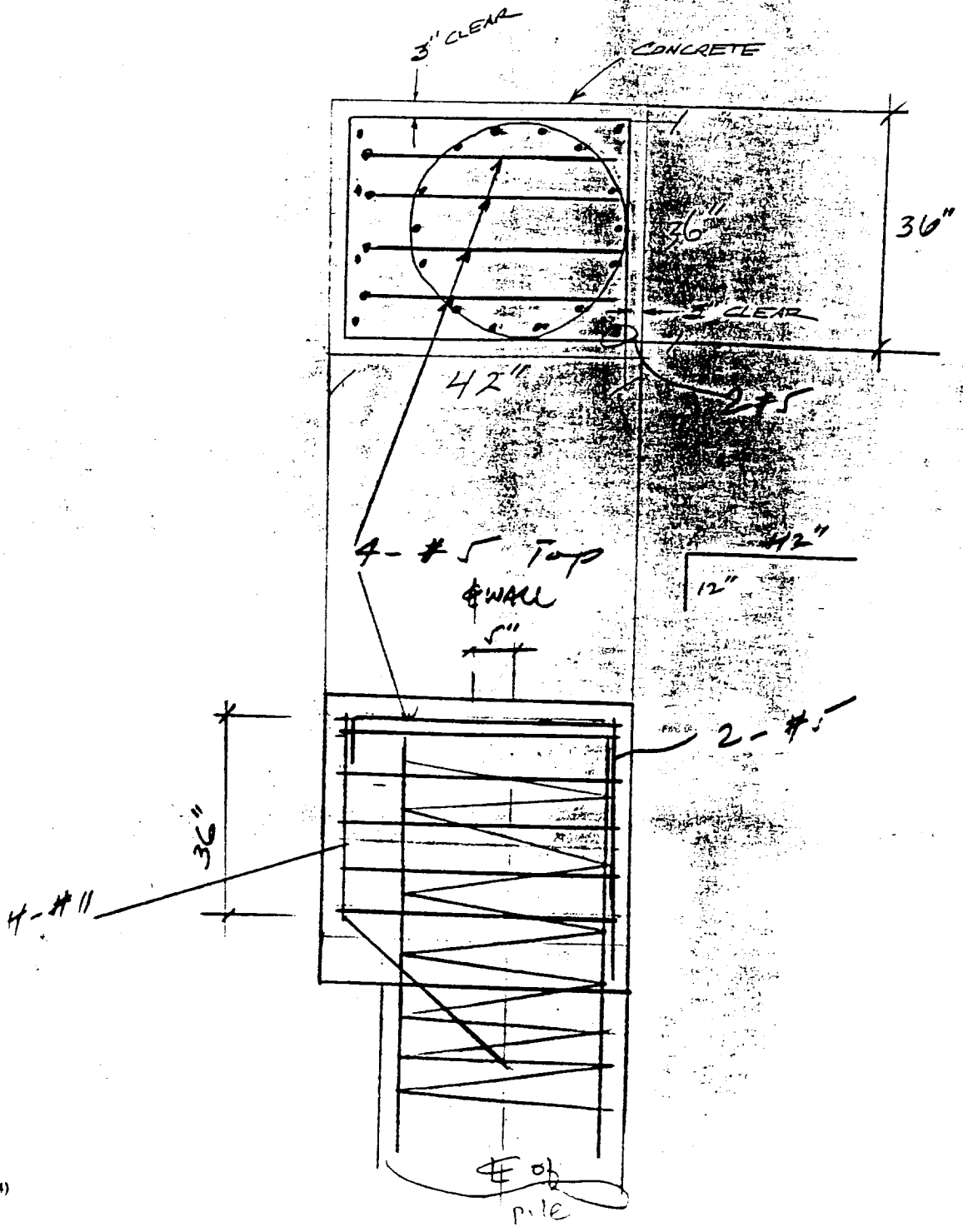

2/12/96

May Affect ROD

Yes
 No
 NA

Initials: SS
 Date: 2/6/96

NONCONFORMANCE REPORT

ENK 2/8/96 Page 1 of 1

1. Line: Contract No: Year: NCR No.: PBL C6435 96 1		2. Contract Name: Reconstruction & Retrofit of Steel & Concrete Bridges		3. Date: 02/07/96	
4. Location: Hill Ave. Underpass Prepared Deck Surface		5. NCR Type: Drill and Bond		6. Contractor/Supplier: Adams & Smith/Macias /Penhall	
7. Specification/Drawing No.: Special Provisions Standard Specs. PARTA3-10-1.21		Drawing No. S-055 83-2 02D(1)		8. Originator: Phone Number: David J. Toschak, P.E. (818)568-0664	
9. Nonconformance description and contract requirements: Concrete Overlay-Typical section of S-055 calls out #5x1'-2" @ 12" both ways. Drill and Bond 7" into existing concrete deck. Of the 1'-2" bar 7" shall remain above deck surface per plan. 512 bars were set on 2/6/96, of these bars 37 extended 9" (+) above the deck surface. Therefore, embedment length has not been achieved.					
10. Resident Engineer: <i>[Signature]</i>		Date: 2-8-96		11. Reply requested from: Adams & Smith/Macias, JV	
				12. Reply due date: 02/14/96	
13. Root cause of the problem (completed by contractor):					
14. Corrective action(s) to prevent recurrence (completed by contractor):					
15. Prepared by:		Date:		16. Implementation Date:	
				17. RE Approval: Date:	
18. Disposition: <input type="checkbox"/> Reject <input type="checkbox"/> Rework <input type="checkbox"/> Repair <input type="checkbox"/> Use-As-Is					
19. Engineer Approval: Print Name: Signature: Date:			20. Resident Engineer: Date:		
21. Verification that nonconforming condition has been corrected:					
22. Inspection: Print Name Signature Date					

2/12/96

May Affect ROD

Yes
 No
 NA

JS *2/8/96*
 Initials Date

NONCONFORMANCE REPORT

ENK 2/8/96 Page 1 of 2

1. Line: Contract No: Year: NCR No: PBL C6435 1996 2			2. Contract Name: Reconstruction & Retrofit of Steel & Concrete Bridges		3. Date: 02/08/96
4. Location: Hill Ave. Underpass Prepared Concrete Deck		5. NCR Type: Drill and Bond Dowel		6. Contractor/Supplier: Adams & Smith/Macias /Penhall	
7. Specification/Drawing No.: Special Provisions Standars Spec. PARTA3-10-1.21 83-2.02D(1)			8. Originator: David J. Toschak, P.E. (818)568-0664		Phone Number:
9. Nonconformance description and contract requirements: Set45 Chemical-Action Concrete used for bonding rebar dowels in existing deck has not been mixed under limitaions of manufactures data. One limitation states water content is critical. The mixing proportions written on Set 45 packaging requires 4 U.S. pints to 50 lbs. (continue on page 2 of 2)					
10. Resident Engineer: <i>[Signature]</i>		Date: <i>2-8-96</i>	11. Reply requested from: Adams & Smith/Macias, JV		12. Reply due date: 02/14/96
13. Root cause of the problem (completed by contractor):					
14. Corrective action(s) to prevent recurrence (completed by contractor):					
15. Prepared by:		Date:	16. Implementation Date:		17. RE Approval: Date:
18. Disposition: <input type="checkbox"/> Reject <input type="checkbox"/> Rework <input type="checkbox"/> Repair <input type="checkbox"/> Use-As-Is					
19. Engineer Approval: Print Name: Signature: Date:			20. Resident Engineer: Date:		
21. Verification that nonconforming condition has been corrected:					
22. Inspection: Print Name Signature Date					



NONCONFORMANCE REPORT
(Continuation Page)

Page 2 of 2

1. Contract No.: C6435	2. Location: Hill Ave. Under- pass Bridge Deck	3. Date: 02/08/96	4. NCR No.: 2
<p>Use of paper cups or plastic soda bottles and the bucket to mix the set 45 are not considered adequate measuring devices. There is a concern for the bond strength.</p>			

Form Q-015 (6/94)