



Los Angeles County
Metropolitan
Transportation
Authority

818 West Seventh Street
Suite 300
Los Angeles, CA 90017

213.623.1194

Janne

October 20, 1995

TO: MTA BOARD OF DIRECTORS
FROM: STANLEY G. PHERNAMBUCQ *[Signature]*
SUBJECT: MTA CONSTRUCTION NONCONFORMANCE REPORTS

Attached please find copies of the Nonconformance Reports (NCRs) received by the MTA Director of Quality Management for the week of October 7 - 19, 1995.

If you have any questions, please call Bill Moore, Director of Quality Management, at 213-244-6109.

SGP:WRM:gg [C-MEMO5WCR-CVR.10]

Attachments

cc: John Adams
Tom Carmichael
Charles Stark
Dave Sievers
Elaine Stewart
Bill Moore
Kim Kimball
Judy Schwartz

W. Lee
10/16/95

May Affect ROD		
<input type="checkbox"/>	<input checked="" type="checkbox"/>	<input type="checkbox"/>
Yes	No	NA
<u>MLL</u>		<u>10/11/95</u>
Initials		Date

Nonconformance Report

1. Line: MRL	Contract No.: B-241	Year: 1995	NCR No.: 160	2. Contract Name: Vermont/Beverly Station		3. Date: 10-10-95
4. Location Inside the station, on the east side, 4' to 9' no. of col. #5.			5. NCR Type: Concrete		6. Contractor: Tutor-Saliba/Perini	
7. B-241 Specification No.: 03200.3.3.A, 03200.3.3.E.1.c.			8. Originator: Robert Kapchan		Phone No.: (213)644-1986	Hold Tag No. NA
9. Contract Requirements: The contractor is required to arrange and place reinforcing as indicated on the approved drawings and as specified in ACI 117. Non-conformance: After stripping form work for Exterior Wall No. 3-E, it was noticed that #9 horizontal rebar was exposed at the bottom of the flute of the architectural finish at 2'-9" and at 4'-5" above the invert for about five linear feet. These flutes are about 7/8" deep. (SEE ATTACHED SKETCH).						
10. Lead Inspector: Ralph W. Ratliff		Date: 10-11-95		11. Reply requested from: Bryan Lee/Holly Cindell		12. Reply due date: 10-13-95
13. Root cause of the problem and action(s) to prevent recurrence (completed by the contractor):						
14. Corrective action(s) (completed by the contractor):						
15. Prepared By:		Date:	16. Implementation Date:		17. RE Approval: Date:	
18. Disposition status: <input type="checkbox"/> Reject <input type="checkbox"/> Rework <input type="checkbox"/> Repair <input type="checkbox"/> Use-As-Is						
19. Engineer approval (Repair and Use-As-Is):			Print Name:	Signature:	Date:	20. Lead Inspector: Date:
21. Verification that nonconforming condition has been corrected:						
22. Inspection:						
			Print Name		Signature Date	

Daily Inspection Report
(Continuation Sheet)

Contract No: B241	Date: 10/9/95
Contractor/Subcontractor: Tutor Saliba Perini	Contract Day No: 665

Sketches:

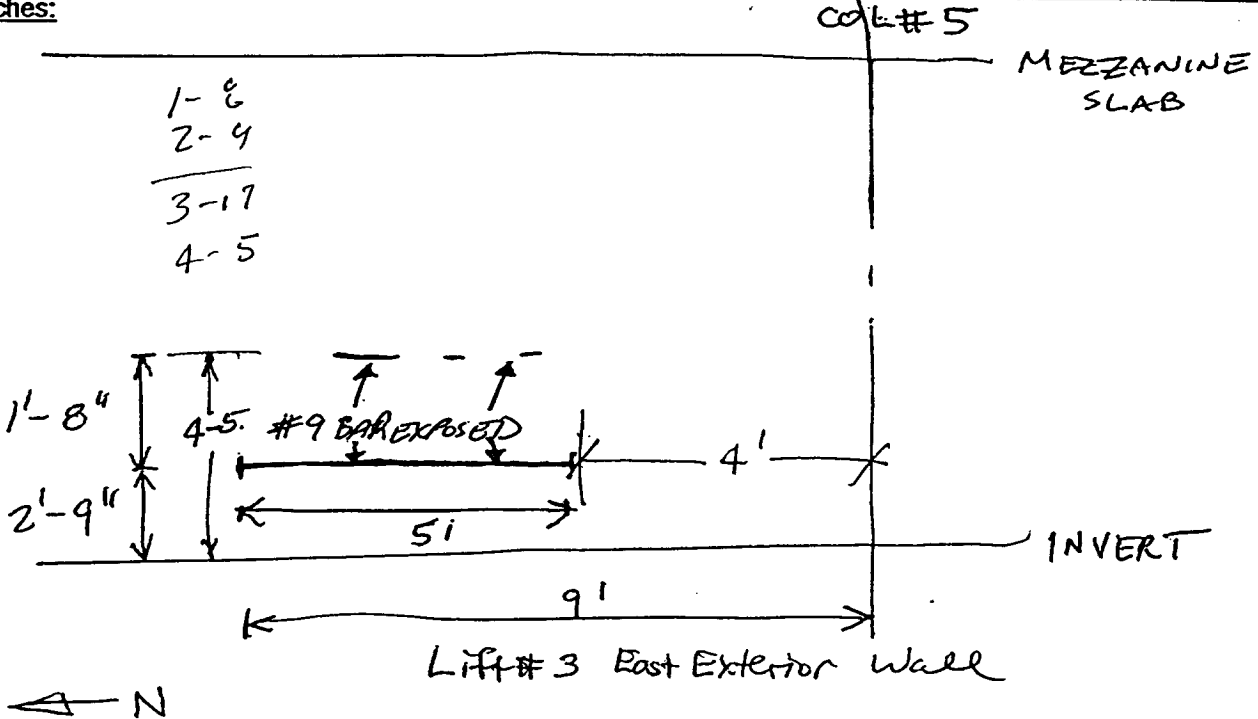

Remarks:

To include completions, revisions, reasons for delays, idle equipment, special instructions to inspectors, utility work, instructions to Contractors, accidents, and Contractor requests.

Upon stripping formwork from Lift # 3 E, it was noticed that # 9 horizontal rebar was exposed @ surface of exterior wall along 2 bars.

See sketch above.

In compliance with Specification Section:	03300	Yes:	<input checked="" type="checkbox"/>	No:	<input type="checkbox"/>
---	-------	------	-------------------------------------	-----	--------------------------

Inspector's Name: ROBERT KAPCHAN
(Print Name)

Signature: Robert Kapchan

Form 143 (9/94)

Time In: 11:00 AM	Time Out: 8:00 PM	Hours: 8.5
-------------------	-------------------	------------

Wlan 10/19/95

May Affect ROD		
<input type="checkbox"/>	<input type="checkbox"/>	<input type="checkbox"/>
Yes	No	NA
_____ Initials		_____ Date

Nonconformance Report

1. Line: MRL	Contract No.: B-241	Year: 1995	NCR No.: 161	2. Contract Name: Vermont/Beverly Station		3. Date: 10-11-95		
4. Location: On Vermont Ave., from Oakwood Ave. to south of Beverly Blv.			5. NCR Type: Street Lighting		6. Contractor: Tutor-Saliba/Perini			
7. B-241 Specification Section/Drawing No.: 02790.1.1.B, 02790.1.1.E, 02790.3.8, 02790.3.9.C, 02790.3.9.G, 02790.3.9.J. Dwg. U-102, U-103.			8. Originator: Reinaldo Rodriguez <i>Reinaldo Rodriguez</i>		Phone No.: (213)644-1986	Hold Tag No. NA		
9. Contract requirement: Maintenance and operation of the temporary lighting system is the contractor's responsibility. Penalties for outages shall commence when lights are out for the third night. The contractor shall provide a daily written report to the Bureau of Street Lighting of all street lights out within one block. Non-conformance Description: As of Monday night, October 02, 1995 and through Wednesday night, October 11, 1995 the street lights on the east and west sides of Vermont Ave. have not been lit. This outage ranges from Oakwood Ave. north and to Midway Ford Co. south of Beverly Blvd.								
10. Lead Inspector: Ralph W. Ratliff <i>Ralph W. Ratliff</i>		Date: 10-12-95		11. Reply requested from: T-S/P, L.K. Comstock		12. Reply due date: 10-13-95		
13. Root cause of the problem and action(s) to prevent recurrence (completed by the contractor):								
14. Corrective action(s) (completed by the contractor):								
15. Prepared By:		Date:		16. Implementation Date:		17. RE Approval: Date:		
18. Disposition status: <input type="checkbox"/> Reject <input type="checkbox"/> Rework <input type="checkbox"/> Repair <input type="checkbox"/> Use-As-Is								
19. Engineer approval (Repair and Use-As-Is):			Print Name: Signature:		Date:		20. Lead Inspector: Date:	
21. Verification that nonconforming condition has been corrected:								
22. Inspection:								
Print Name			Signature			Date		

W
10/14/95

May Affect ROD		
<input type="checkbox"/>	<input checked="" type="checkbox"/>	<input type="checkbox"/>
Yes	No	NA
<i>DB</i>		<i>7/21</i>
Initials		Date

Nonconformance Report

1. Line: MRL	Contract No.: B261	Year: 1995	NCR No.: 58	2. Contract Name: Vermont / Sunset Station		3. Date: 7/20/95
4. Location Station Area			5. NCR Type: Excavation		6. Contractor/Supplier: Tutor Saliba Perini	
7. Specification Section/Drawing No.: SS-006A and TSP Drawing No. S-6			8. Originator: Emanuel Douglas <i>EDA</i>		Phone No.: 953-2792	Hold Tag No. N/A
9. Contract requirement and nonconformance description: 1. Nonconformance: Excavation between SP-41 through SP-66 is exceeding the 3' below the wale and the 6'x12' bench requirements as listed of SS-006A and TSP Drawing S-6. Excavation in areas listed should be corrected immediately to get your excavation back in compliance with the contract documents. 2. "A" Level struts at south end are not in place but are required to be when the excavation is at it's present elevation. Every effort should be made to correct the problem so as not to impede the job progress. An evaluation will be performed on 7/24/95 to verify the problem area has been corrected.						
10. Lead Inspector: Emanuel Douglas <i>Emanuel Douglas</i>		Date: 7/20/95		11. Reply requested from: Project Manager Peter Clark		12. Reply due date: July 27, 1995
13. Root cause of the problem and action(s) to prevent recurrence (completed by the contractor): Benches were removed to set wales.						
14. Corrective action(s) (completed by the contractor): Benches were replaced at the south end and between SP-41 through SP-66.						
15. Prepared By: <i>Peter A. Clark</i> Peter A. Clark		Date: 7/25/95		16. Implementation Date:		17. RE Approval: <i>[Signature]</i> Date: 10/12/95
18. Disposition status: <input type="checkbox"/> Reject <input checked="" type="checkbox"/> Rework <input type="checkbox"/> Repair <input type="checkbox"/> Use-As-Is						
19. Engineer approval (Repair and Use-As-Is):			Print Name: N/A		Signature: <i>[Signature]</i>	
			Date:		20. Lead Inspector: <i>Emanuel Douglas</i>	
					Date: 10/12/95	
21. Verification that nonconforming condition has been corrected: TSP HAS CORRECTED HIS EXCAVATION SEQUENCE SO THAT THE WORK IS BEING PERFORMED IN ACCORDANCE WITH DRAWING No. SS-006A, SUBMITTAL No. DIAGD-1.4A-2 AND RFI-5019.00, THIS NCR CAN BE CLOSED.						
22. Inspection: EMANUEL DOUGLAS Print Name <i>Emanuel Douglas</i> Signature 10/12/95 Date						

May Affect ROD		
<input type="checkbox"/> Yes	<input type="checkbox"/> No	<input type="checkbox"/> NA
Initials		Date

Wha
16/16/95

Nonconformance Report

1. Line: MRL	Contract No: B261	Year: 1995	NCR No.: 059	2. Contract Name: Vermont/Sunset Station	3. Date: 7/26/95
4. Location Strut Levels A & B		5. NCR Type: Strut to Wale Connection		6. Contractor/Supplier: Tutor-Saliba-Perini	
7. Specification Section/Drawing No.: Contract Drawing No. SS-006 Tutor-Saliba-Perini, Drawing D-1			8. Originator: Emanuel Douglas	Phone No.: 953-2792	Hold Tag No.: N/A
9. Contract requirement and nonconformance description: Nonconformance: Strut to wale connection shown on TSP Dwg. No. D-1 did not consider the review comment in the fabrication or the installation of the struts and wales. Consideration of the review comments is a condition of the Approved as Noted status of the submittal. The rejected portion of the submittal requires an immediate response so it will not further impact the job progress.					
10. Lead Inspector: Emanuel Douglas		Date: 7/26/95	11. Reply requested from: Project Manager, Peter Clark		12. Reply due date: August 1, 1995
13. Root cause of the problem and action(s) to prevent recurrence (completed by the contractor): The majority of the drawing D-1 is strut to wale connection. If EMC did not approve the details shown they should have stamped them as rejected and not approved as noted, resubmittal required. We also want to remind P-D and EMC that Job B241 had the same connection details and was approved by EMC.					
14. Corrective action(s) (completed by the contractor): Pursuant to a meeting with EMC & P-D, a new drawing is submitted for levels C & D with vertical 3/4" bearing plates.					
15. Prepared By: Peter A. Clark		Date: 7/31/95	16. Implementation Date:	17. RE Approval: <i>[Signature]</i>	Date: 10/4/95
18. Disposition status: <input type="checkbox"/> Reject <input checked="" type="checkbox"/> Rework <input type="checkbox"/> Repair <input checked="" type="checkbox"/> Use-As-Is					
19. Engineer approval (Repair and Use-As-Is):		Print Name: Eli Chouinard	Signature: <i>[Signature]</i>	Date: 10/4/95	20. Lead Inspector: Emanuel Douglas
21. Verification that nonconforming condition has been corrected: PD inspected levels A & B for eccentricities per the new criteria established in the revised submittal.					
22. Inspection: THIS WORK WAS CORRECTED AS PER THE LATEST REVISION BY EMC, THIS WORK IS NOW ACCEPTABLE. EMANUEL DOUGLAS Print Name <i>[Signature]</i> Signature 10-12-95 Date					

RECEIVED
OCT 05 1995
PARSONS-D'AMICO



Metropolitan Transportation Authority

WRW
10/16/95

May Affect ROD		
<input checked="" type="checkbox"/> Yes	<input type="checkbox"/> No	<input type="checkbox"/> NA
<i>DR</i>	<i>10-11-95</i>	
Initials	Date	

Nonconformance Report

1. Line: MRL	Contract No.: C331	Year: 95	NCR No.: 69.00	2. Contract Name: TUNNELS, NORTH HOLLYWOOD STATION TO	3. Date: 10/11/95
------------------------	------------------------------	--------------------	--------------------------	---	-----------------------------

4. Location: AL TUNNEL	5. NCR Type: Excavation & Support	6. Contractor/Supplier: OBAYASHI
----------------------------------	---	--

7. Specification Section/Drawing No.: 02311 3.6 /	8. Originator: ROBERT W VEATCH <i>R.W.V.</i>	Phone No.: (818) 752-9876	Hold Tag No.:
---	--	-------------------------------------	----------------------

9. Contract Requirement:
DEPARTURE OF THE TUNNEL FROM THE INDICATED LINE AND GRADE, MAXIMUM OF FOUR INCHES

Nonconformance Description:

DAILY INSPECTION REPORTS SHOW THAT TOLERANCES WERE EXCEEDED ON 10/9/95 AND 10/10/95

10. Lead Inspector: R.W. VEATCH <i>RWV</i>	Date: 10/11/95	11. Reply Requested From: CARL LINDEN	12. Reply Due Date: 10/19/95
--	--------------------------	---	--

13. Root cause of the problem and action(s) to prevent recurrence (Completed by the contractor):

14. Corrective action(s) (Completed by the contractor):

15. Prepared By:	Date:	16. Implementation Date:	17. RE Approval:	Date:
-------------------------	--------------	---------------------------------	-------------------------	--------------

18. Disposition Status: Reject Rework Repair Use-As-Is

19. Engineer Approval: (Repair and Use-As-Is):	Print Name:	Signature:	Date:	20. Lead Inspector:	Date:
--	--------------------	-------------------	--------------	----------------------------	--------------

21. Verification that nonconforming condition has been corrected:

22. Inspection:

Print Name: _____ Signature: _____ Date: _____



Metropolitan Transportation Authority

Nonconformance Report

WJW
10/16/95

May Affect ROD		
<input type="checkbox"/> Yes	<input checked="" type="checkbox"/> No	<input checked="" type="checkbox"/> NA
DJ Initials		10-11-95 Date

1. Line: MRL	Contract No.: C331	Year: 95	NCR No.: 70.00	2. Contract Name: TUNNELS, NORTH HOLLYWOOD STATION TO	3. Date: 10/11/95
-----------------	-----------------------	-------------	-------------------	--	----------------------

4. Location: AL TUNNEL	5. NCR Type: Excavation & Support	6. Contractor/Supplier: OBAYASHI
---------------------------	--------------------------------------	-------------------------------------

7. Specification Section/Drawing No.: 02330 3.1 A6 /	8. Originator: ROBERT W VEATCH <i>RWV</i>	Phone No.: (818) 752-9876	Hold Tag No.:
---	---	------------------------------	---------------

9. Contract Requirement:
PUMP INVERT GROUT HOLES WHEN TRAILING HAS MOVED PASSED, AND NO FURTHER USE IS NEED FOR THESE HOLES

Nonconformance Description:
OBAYASHI HAS FAILED TO GROUT THESE HOLES WHEN TRAILING PASSED IN A TIMELY MANNER

10. Lead Inspector: R.W. VEATCH <i>RWV</i>	Date: 10/11/95	11. Reply Requested From: CARL LINDEN	12. Reply Due Date: 10/19/95
---	-------------------	--	---------------------------------

13. Root cause of the problem and action(s) to prevent recurrence (Completed by the contractor):

14. Corrective action(s) (Completed by the contractor):

15. Prepared By:	Date:	16. Implementation Date:	17. RE Approval:	Date:
------------------	-------	--------------------------	------------------	-------

18. Disposition Status: Reject Rework Repair Use-As-Is

19. Engineer Approval: (Repair and Use-As-Is):	Print Name:	Signature:	Date:	20. Lead Inspector:	Date:
---	-------------	------------	-------	---------------------	-------

21. Verification that nonconforming condition has been corrected:

22. Inspection:

Print Name: _____ Signature: _____ Date: _____



Metropolitan Transprotation Authority

WPU
10/16/95

Nonconformance Report

May Affect ROD		
<input type="checkbox"/>	<input type="checkbox"/>	<input checked="" type="checkbox"/>
Yes	No	NA
<i>WPU</i>		10-11-95
Initials		Date

1. Line: MRL	Contract No.: C331	Year: 95	NCR No.: 71.00	2. Contract Name: TUNNELS, NORTH HOLLYWOOD STATION TO	3. Date: 10/11/95
4. Location: AL TUNNEL		5. NCR Type: Excavation & Support		6. Contractor/Supplier: OBAYASHI	
7. Specification Section/Drawing No.: 02330 3.1 A6 /			8. Originator: ROBERT W. VEATCH <i>RWV</i>		Phone No.: (818) 752-9876
9. Contract Requirement: FILL THE SPACE BETWEEN THE TUNNEL SUPPORT AND THE EXCAVATED SURFACE WITHIN 16 HRS.					
Nonconformance Description: OBAYASHI HAS FAILED TO CONTACT GROUT THE SEGMENTS INSTALLED ON 10/10/95, SEGMENTS #342 THRU 348 WITHIN THE TIME LIMIT. THIRTEENTH NCR FOR THIS CONDITION					
10. Lead Inspector: R.W. VEATCH <i>RWV</i>		Date: 10/11/95		11. Reply Requested From: CARL LINDEN	
12. Reply Due Date: 10/19/95					
13. Root cause of the problem and action(s) to prevent recurrence (Completed by the contractor):					
14. Corrective action(s) (Completed by the contractor):					
15. Prepared By:		Date:		16. Implementation Date:	
				17. RE Approval:	
				Date:	
18. Disposition Status: <input type="checkbox"/> Reject <input type="checkbox"/> Rework <input type="checkbox"/> Repair <input type="checkbox"/> Use-As-Is					
19. Engineer Approval: (Repair and Use-As-Is):			Print Name:		Signature:
					Date:
20. Lead Inspector: Date:					
21. Verification that nonconforming condition has been corrected:					
22. Inspection:					
		Print Name:		Signature:	
				Date:	



Metropolitan Transportation Authority

WRV
10/16/95

May Affect ROD		
<input type="checkbox"/>	<input type="checkbox"/>	<input checked="" type="checkbox"/>
Yes	No	NA
<i>DR</i>		<i>10-11-95</i>
Initials		Date

Nonconformance Report

1. Line: MRL	Contract No.: C331	Year: 95	NCR No.: 72.00	2. Contract Name: TUNNELS, NORTH HOLLYWOOD STATION TO	3. Date: 10/11/95
------------------------	------------------------------	--------------------	--------------------------	---	-----------------------------

4. Location: AL TUNNEL	5. NCR Type: Excavation & Support	6. Contractor/Supplier: OBAYASHI
----------------------------------	---	--

7. Specification Section/Drawing No.: 02330 3.1 A6 /	8. Originator: ROBERT W VEATCH <i>WRV</i>	Phone No.: (818) 752-9876	Hold Tag No.:
--	---	-------------------------------------	----------------------

9. Contract Requirement:
FILL THE SPACE BETWEEN THE TUNNEL SUPPORT AND THE EXCAVATED SURFACE WITHIN 16 HRS.

Nonconformance Description:
OBAYASHI HAS FAILED TO CONTACT GROUT SEGMENTS#336-337-338-339 WITHIN THE THE TIME LIMIT -- TWELFTH NCR FOR THIS CONDITION

10. Lead Inspector: R.W. VEATCH <i>WRV</i>	Date: 10/11/95	11. Reply Requested From: CARL LINDEN	12. Reply Due Date: 10/19/95
--	--------------------------	---	--

13. Root cause of the problem and action(s) to prevent recurrence (Completed by the contractor):

14. Corrective action(s) (Completed by the contractor):

15. Prepared By:	Date:	16. Implementation Date:	17. RE Approval:	Date:
-------------------------	--------------	---------------------------------	-------------------------	--------------

18. Disposition Status: Reject Rework Repair Use-As-Is

19. Engineer Approval: (Repair and Use-As-Is):	Print Name:	Signature:	Date:	20. Lead Inspector:	Date:
--	--------------------	-------------------	--------------	----------------------------	--------------

21. Verification that nonconforming condition has been corrected:

22. Inspection:

Print Name: _____ Signature: _____ Date: _____



Metropolitan Transportation Authority

WRV 10/16/95

May Affect ROD		
<input type="checkbox"/> Yes	<input checked="" type="checkbox"/> No	<input type="checkbox"/> NA
Initials		Date

Nonconformance Report

Page 1 of 1

1. Line: MRL	Contract No.: C331	Year: 95	NCR No.: 73.00	2. Contract Name: TUNNELS, NORTH HOLLYWOOD STATION TO	3. Date: 10/11/95
------------------------	------------------------------	--------------------	--------------------------	---	-----------------------------

4. Location: AL TUNNEL	5. NCR Type: Excavation & Support	6. Contractor/Supplier: OBAYASHI
----------------------------------	---	--

7. Specification Section/Drawing No.: 02311 3.5 A2 A4 /	8. Originator: ROBERT W VEATCH <i>RWV</i>	Phone No.: (818) 752-9876	Hold Tag No.:
---	---	-------------------------------------	----------------------

9. Contract Requirement:
EXCAVATE THE FACE TO PREVENT LOSS OF GROUND BY CONTINUOUSLY CONTROLLING THE EXCAVATED FACE.

Nonconformance Description:
NO POSITIVE MEANS OF FACE CONTROL USED ON 10/09/95 OR 10/10/95 WHILE EXCAVATING THE AL TUNNEL.

10. Lead Inspector: R.W. VEATCH <i>RWV</i>	Date: 10/11/95	11. Reply Requested From: CARL LINDEN	12. Reply Due Date: 10/19/95
--	--------------------------	---	--

13. Root cause of the problem and action(s) to prevent recurrence (Completed by the contractor):

14. Corrective action(s) (Completed by the contractor):

15. Prepared By:	Date:	16. Implementation Date:	17. RE Approval:	Date:
-------------------------	--------------	---------------------------------	-------------------------	--------------

18. Disposition Status: Reject Rework Repair Use-As-Is

19. Engineer Approval: (Repair and Use-As-Is):	Print Name:	Signature:	Date:	20. Lead Inspector:	Date:
--	--------------------	-------------------	--------------	----------------------------	--------------

21. Verification that nonconforming condition has been corrected:

22. Inspection:

Print Name: _____ Signature: _____ Date: _____



Metropolitan Transportation Authority

WV 10/19/95

May Affect ROD		
<input type="checkbox"/> Yes	<input type="checkbox"/> No	<input checked="" type="checkbox"/> NA
<i>DA</i>		10-12-95
Initials		Date

Nonconformance Report

1. Line: MRL	Contract No.: C331	Year: 95	NCR No.: 74.00	2. Contract Name: TUNNELS, NORTH HOLLYWOOD STATION TO	3. Date: 10/12/95
-----------------	-----------------------	-------------	-------------------	--	----------------------

4. Location: AL TUNNEL	5. NCR Type: Excavation & Support	6. Contractor/Supplier: OBAYASHI
---------------------------	--------------------------------------	-------------------------------------

7. Specification Section/Drawing No.: 02311 3.5 A2 A4 /	8. Originator: ROBERT W VEATCH <i>R.W.V.</i>	Phone No.: (818) 752-9876	Hold Tag No.:
--	---	------------------------------	---------------

9. Contract Requirement:
EXCAVATE THE FACE TO PREVENT LOSS OF GROUND BY CONTINUOUSLY CONTROLLING THE EXCAVATED FACE.

Nonconformance Description:
NO POSITIVE MEANS OF FACE CONTROL WAS USED ON 10/11/95 WHILE EXCAVATING THE AL TUNNEL. RESULTING IN LOSS GROUND OVER THE SHIELD.

10. Lead Inspector: R.W. VEATCH <i>R.W.V.</i>	Date: 10/12/95	11. Reply Requested From: CARL LOINDEN	12. Reply Due Date: 10/19/95
--	-------------------	---	---------------------------------

13. Root cause of the problem and action(s) to prevent recurrence (Completed by the contractor):

14. Corrective action(s) (Completed by the contractor):

15. Prepared By:	Date:	16. Implementation Date:	17. RE Approval:	Date:
------------------	-------	--------------------------	------------------	-------

18. Disposition Status: Reject Rework Repair Use-As-Is

19. Engineer Approval: (Repair and Use-As-Is):	Print Name:	Signature:	Date:	20. Lead Inspector:	Date:
---	-------------	------------	-------	---------------------	-------

21. Verification that nonconforming condition has been corrected:

22. Inspection:

Print Name: Signature: Date:



Metropolitan Transportation Authority

Nonconformance Report

WR 10/19/95

May Affect ROD

Yes No NA

DA *10-2-95*

Initials Date

1. Line: MRL	Contract No.: C331	Year: 95	NCR No.: 75.00	2. Contract Name: TUNNELS, NORTH HOLLYWOOD STATION TO	3. Date: 10/12/95
-----------------	-----------------------	-------------	-------------------	--	----------------------

4. Location: AL TUNNEL	5. NCR Type: Excavation & Support	6. Contractor/Supplier: OBAYASHI
---------------------------	--------------------------------------	-------------------------------------

7. Specification Section/Drawing No.: 02330 3.1 A6 /	8. Originator: ROBERT W. VEATCH <i>RV</i>	Phone No.: (818) 752-9876	Hold Tag No.:
---	--	------------------------------	---------------

9. Contract Requirement:
FILL THE SPACE BETWEEN THE TUNNEL SUPPORT AND THE EXCAVATED SURFACE WITHIN 16 HRS.

Nonconformance Description:
OBAYASHI HAS FAILED TO CONTACT GROUT THE SEGMENTS INSTALLED ON 10/11/95, SEGMENTS #365 THRU # 371 WITHIN THE TIME LIMIT .FOURTEENTH NCR FOR THIS CONDITION.

10. Lead Inspector: R.W. VEATCH <i>RV</i>	Date: 10/12/95	11. Reply Requested From: CARL LINDEN	12. Reply Due Date: 10/19/95
--	-------------------	--	---------------------------------

13. Root cause of the problem and action(s) to prevent recurrence (Completed by the contractor):

14. Corrective action(s) (Completed by the contractor):

15. Prepared By:	Date:	16. Implementation Date:	17. RE Approval:	Date:
------------------	-------	--------------------------	------------------	-------

18. Disposition Status: Reject Rework Repair Use-As-Is

19. Engineer Approval: (Repair and Use-As-Is):	Print Name:	Signature:	Date:	20. Lead Inspector:	Date:
---	-------------	------------	-------	---------------------	-------

21. Verification that nonconforming condition has been corrected:

22. Inspection:

Print Name: Signature: Date:

10/18/95

NONCONFORMANCE REPORT

Page of

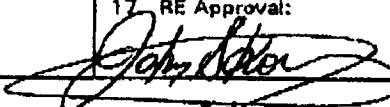
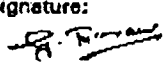
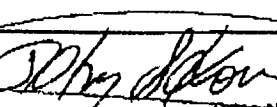
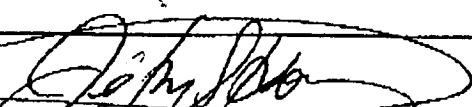
1. Contract No: PBL C6410		Year: 1995		NCR No.: 22		2. Contract Name: L.A. River Bridge.		3. Date: 7-14-95									
4. Location: Pier #6, Back span curb			5. NCR Type: concrete			6. Contractor/Supplier: Kiewit											
7. Specification/Drawing No.: Contract specification 3301					8. Originator: Eddie Bolandi					Phone Number: 213-222 9064.							
9. Nonconformance description and contract requirements: The concrete that was placed into the curbs on July 13th 1995 is questionable. No test sample were taken by the contractor quality control representative. Per contract specification 3301. You must quality this concrete.																	
10. Inspector: Eddie Bolandi			Date: 7-14-95			11. Reply requested from: Kiewit			12. Reply due date: 7-19-95								
13. Root cause of the problem (completed by contractor): A scheduling misinterpretation occurred between Kiewit and subcontractor, regarding a request for an on-site concrete inspector.																	
14. Corrective action(s) to prevent recurrence (completed by contractor): We plan on bringing Smith Emery on site to perform a non-destructive test to quality the concrete. Two areas will be chosen and ten readings will be taken at each area. The tests will be compared to previously poured barrier with known compressive strengths. (TEST #ASTM C805-85) All pours will have SE on-site.																	
15. Prepared by: Don Hemmway			Date: 7-21-95			16. Implementation Date:			17. RE Approval: 			Date: 8/17/95					
18. Disposition: <input type="checkbox"/> Reject <input type="checkbox"/> Rework <input type="checkbox"/> Repair <input checked="" type="checkbox"/> Use-As-is																	
19. Engineer Approval: Giri Takrali			Print Name: Giri Takrali			Signature: 			Date: 10/03/95			20. Inspector: Eddie Bolandi			Date: 10/3/95		
21. Verification that nonconforming condition has been corrected:																	
22. Inspection:  										Date: 10/3/95							

OCT 10

COPY 10/18/95
DAN ESTRADA
NONCONFORMANCE REPORT

May Affect RC:
 Yes No NA
 Z. H. 8/3
 Initials Date

Page 1 of 2

1. Line: Contract No: C6430 Year: 95 NCR No.: 16		2. Contract Name: ARROYO SECO BRIDGE REC.		3. Date: 8/3/95	
4. Location: R#3-1 ELEV. 542.32 STA. 401+64 TO 405+30		5. NCR Type: STRUCTURE BACKFILL		6. Contractor/Supplier: KIEWIT	
7. Specification/Drawing No.: SPEC. SECT. H. 02200-2.2			8. Originator: JERGE PANTOJA Phone Number: (213) 252-7264		
9. Nonconformance description and contract requirements: STRUCTURE BACKFILL MATERIAL BROUGHT IN FROM THE L.A. RIVER STOCKPILE FAILED TO MEET SPECIFICATION GRADATION REQUIREMENTS. SEE ATTACHED REPORT.					
10. Resident Engineer: Rich Hebert Date: 8/3/95		11. Reply requested from: JEFF ELLIS		12. Reply due date: 8/10/95	
13. Root cause of the problem (completed by contractor): SEE ATTACHED LETTER					
14. Corrective action(s) to prevent recurrence (completed by contractor): SEE ATTACHED LETTER			* REVIEWED THE GRADATION TEST RESULTS. QUESTIONS WERE DISCUSSED ON 9/28/95, WITH T. WALLER, PANTOJA AND MAA ENGINEER IN THE TESTING LAB. THE USE-AS-IS DISPOSITION IS ACCEPTABLE		
15. Prepared by: J. ELMS Date: 8-7-95		16. Implementation Date:		17. RE Approval: _____ Date:	
18. Disposition: <input checked="" type="checkbox"/> Reject <input type="checkbox"/> Rework <input type="checkbox"/> Repair <input checked="" type="checkbox"/> Use-As-Is					
19. Engineer Approval: K. S. HANDRA Print Name: _____ Signature: _____ Date: 10/6/95		20. Resident Engineer: T. Waller Date: 9/28/95			
21. Verification that nonconforming conditions have been corrected: AS AGREED BY MTC & KPR A SAMPLE OF THE STRUCTURE BACKFILL MATERIAL IN QUESTION (L.A. RIVER STOCKPILE) ALREADY IN PLACE, WAS COLLECTED FROM STA. 402+00 @ ELEV. 552.0, 6' FROM SOUTH FACE OF R#3-1. THE SAMPLE WAS COLLECTED BY MTC'S LAB (MAA) & KPR LAB (SMITH-EMERY). THE SAMPLE WAS SPLIT AND TESTED FOR GRADATION. (SEE ATTACHED REPORT FOR GRADATION RESULTS). AFTER REVIEWING THE PASSING RESULTS, MTC FEELS THE FAILED TEST WAS AN ANOMALY.					
22. Inspection: JERGE PANTOJA Print Name: _____ Signature: _____ Date: 9/21/95					

C.E.
R. HULSE
DCC(2)

Yes	No	NA
_____	_____	_____
Initials	Date	

RECEIVED
OCT 09 1995
 MANAGERS OF TRANSIT CONSTRUCTION

NONCONFORMANCE REPORT

Page _____ of _____

1. Line: Contract No: C 6430		Year: 95		NCR No.: # 20		2. Contract Name: ARROYO SECO BRIDGE		3. Date: 09 / 21 / 95	
4. Location: CIDH PILE #399 STA. 399 + 57.85			5. NCR Type: CIDH PILE			6. Contractor/Supplier: GENCE CORP.			
7. Specification/Drawing No.: 02387-1 E.1.b					8. Originator: TED LEPE		Phone Number: (213) 258-7284		
9. Nonconformance description and contract requirements: THE ABOVE LISTED PILE IS IN VIOLATION OF THE ALLOWED 3" TOLERANCE AS SPECIFIED IN SECTION 02387-1. 2 E. 1.b									
10. Resident Engineer: <i>Tom C. Walker</i>			Date: 9/21/95		11. Reply requested from: <i>KIEWIT PACIFIC</i> <i>JEFF ELLIS</i>			12. Reply due date: <i>09-28-95</i>	
13. Root cause of the problem (completed by contractor): UNKNOWN - ALL OF THE NECESSARY LAYOUT HAS BEEN PROVIDED BY KIEWIT PACIFIC CO. TO GET THE PILE CAGES IN THE CORRECT LOCATION. THE SUBCONTRACTOR JUST FAILED TO DO SO.									
14. Corrective action(s) to prevent recurrence (completed by contractor): THE SUBCONTRACTOR, GENCE CORP., IS ALIGNING THE PILE CAGES BETWEEN THE OFFSETS PROVIDED. GENCE CORP. HAS OFFERED THE ATTACHED SOLUTION TO CORRECT PILE # 399.									
15. Prepared by: J. ELLIS			Date: 10-6-95		16. Implementation Date:		17. RE Approval: _____ Date: _____		
18. Disposition: <input type="checkbox"/> Reject <input type="checkbox"/> Rework <input type="checkbox"/> Repair <input type="checkbox"/> Use-As-Is									
19. Engineer Approval: _____ Print Name: _____ Signature: _____ Date: _____					20. Resident Engineer: _____ Date: _____				
21. Verification that nonconforming condition has been corrected:									
22. Inspection: _____ Print Name _____ Signature _____ Date _____									

10/16/95

Initials: *[Signature]*
 No: *10/9/95*
 Date: *10/9/95*

NONCONFORMANCE REPORT

Page of

1. Line Contract No: C6430		Year: 1995		NCR No: #23		2. Contract Name: ARROYO SECO BRIDGE		3. Date: 10/9/95		
4. Location: Wall 4-1 piles 380,381,382,383,384 pilaster's				5. NCR Type: CAST -in-place Conc.			6. Contractor/Supplier: MARMALEJO			
7. Specification/Drawing No.: SPEC.03300-2 4.C.& D.					8. Originator: Ted Lepe Phone Number: 258-7284					
9. Nonconformance description and contract requirements: Mix Design 104x78 WRDA -79/5 was not submitted for approval as specified in section 01460 and 03300-2 4.C. & D.										
10. Resident Engineer: <i>[Signature]</i>			Date: 10/9/95		11. Reply requested from: JEFF ELLIS (KPC)/MARMALEJO			12. Reply due date: 10.16.95		
13. Root cause of the problem (completed by contractor):										
14. Corrective action(s) to prevent recurrence (completed by contractor):										
15. Prepared by:			Date:		16. Implementation Date:			17. RE Approval:		Date:
8. Disposition: <input type="checkbox"/> Reject <input type="checkbox"/> Rework <input type="checkbox"/> Repair <input type="checkbox"/> Use-As-Is										
9. Engineer Approval: Print Name: Signature: Date:					20. Resident Engineer: Date:					
1. Verification that nonconforming condition has been corrected:										
. Inspection: Print Name Signature Date										