

Mariachi Plaza Joint Development Proposal Item #13

November 5, 2014



Metro

Metro Property

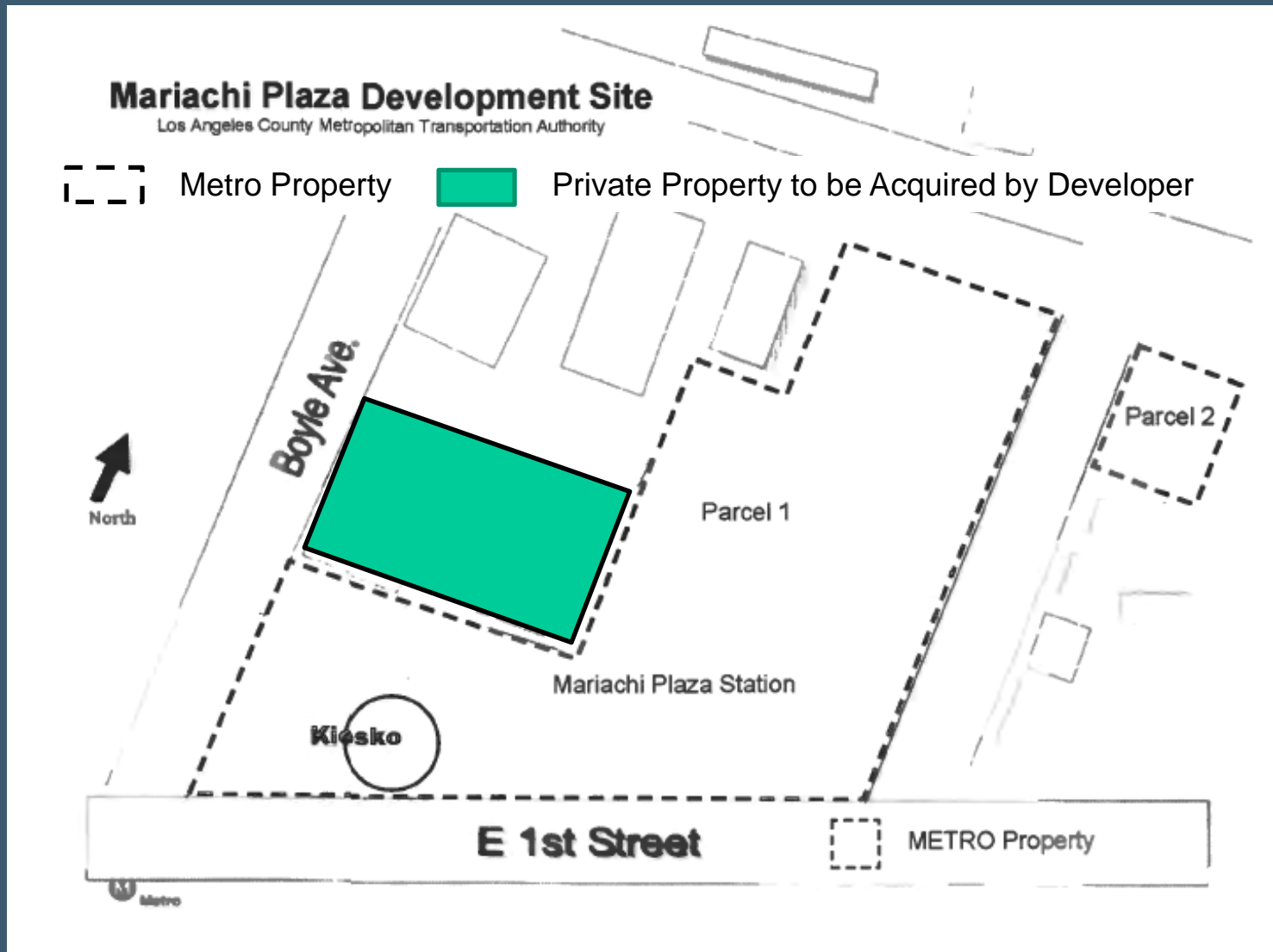

Metro

Project Timeline

- Dec. 2013 - Request for Proposal (RFP) released
- Apr. 2014 - Four (4) proposals received
- Sep. 2014 - Interviews
- Nov. 2014 - ENA signed upon Board approval
- In 18 months – CEQA findings, Joint Development Agreement and Ground Lease brought to Metro Board



Metro

Selected Developer Team & Proposal

- Developer: Primestor Development, Inc
- Architect: Gensler
- Entitlements Consultant: Sheppard Mullin
- Proposed Development: 2 buildings, one 3-stories and one 8-stories, with a total of 120,570 sq ft of commercial space.

Proposed Site Plan

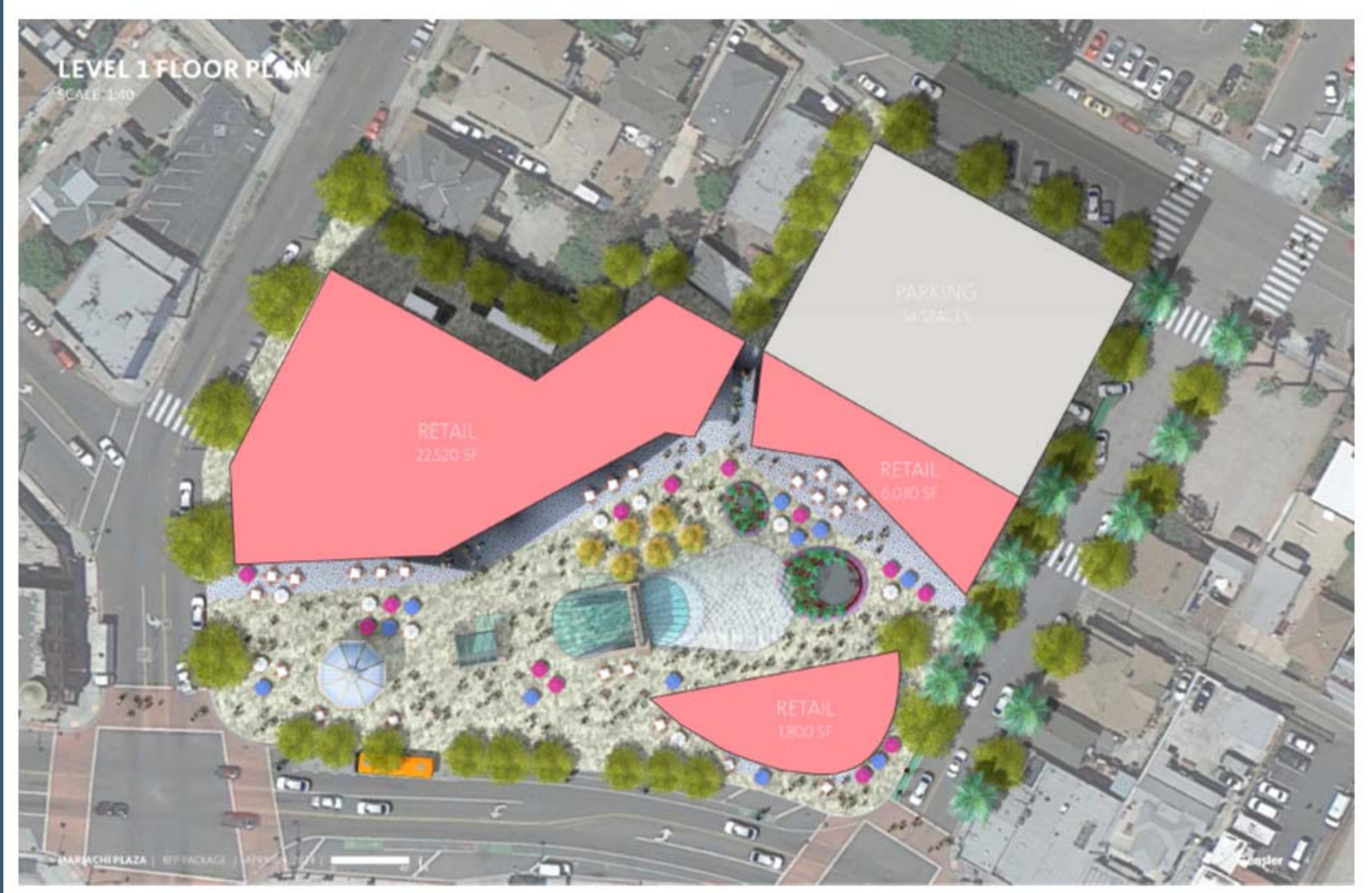

Metro

Rendering

